

TECHNOLOGY AND INSIGHT FOR CONSULTING, MECHANICAL & FACILITY ENGINEERS

# ES ENGINEERED SYSTEMS

SEPTEMBER 2015  
Vol. 32 No.9  
A bnp PUBLICATION

## BEFORE & AFTER

The incredibly unhelpful existing chiller plant layout threw down the gauntlet. The retrofit design team picked it up and ran with it.

### INSIDE ▶

- ▶ Wavelengths For HVAC / pg 19
- ▶ The Boiler Retrofit Big Picture / pg 32
- ▶ Build A Mentoring Process / pg 59

# SOFTWARE & APPS

## MOBILE APP



Trane has introduced Trane® 360°, a mobile app that allows users to get instant access to Trane products and company information. Trane 360° is a free downloadable app that provides up-to-date product information, product literature, and the nearest parts locations and available inventory. Users can also look up a customer's order history, find product information, and locate a nearest sales center. Trane 360° is optimized for performance on several of the most recent models of Apple and Android mobile tablet devices.

— Trane

[www.Trane.com/Trane360](http://www.Trane.com/Trane360)

## PIPING SOFTWARE

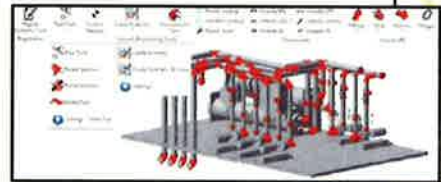

Victaulic launched Victaulic Tools for Revit, an Autodesk® Revit® MEP add-in which the company says increases drawing productivity, solves troublesome pipe routing problems, and enables the creation of construction and fabrication documentation within Revit. Victaulic Tools for Revit aims to help users to route pipe twice as fast and increase efficiency and productivity. Features that increase routing efficiency include pipe splitting, rotate selection, resize selection, delete pipe, family lookup, and more.

— Victaulic

[www.victaulicsoftware.com](http://www.victaulicsoftware.com)

## BUILDING MANAGEMENT

Honeywell updated its flagship building management system, Enterprise Buildings Integrator (EBI). The system aims to help security and facility personnel streamline and improve visitor management and access control. The updates enable tight coordination and easier integration with technologies from HID, SALTO, and SARGENT®, tying products into a common user interface. The company says users will benefit from a consistent look and feel through EBI, which will help them manage safety and security operations more efficiently.



— Honeywell

[www.ebi.honeywell.com](http://www.ebi.honeywell.com)

## ENERGY SOFTWARE

**alliantgroup**

Tax service company alliantgroup has released its new proprietary software interface, epFace, which allows firms to optimize its modeling calculations for energy-based tax deductions. The company says it works with firms that design and develop technical specifications to help them claim tax deductions for their design work on government-owned buildings that meet energy efficiency standards under the law. Designed in-house by alliantgroup, epFace was designed to allow for more accurate and specific calculations while capturing the federal tax deduction established in section 179D, The Energy Efficient Commercial Building Deduction.

— alliantgroup

[www.alliantgroup.com](http://www.alliantgroup.com)

## UV MONITOR

The UV-Com™ Control Panel from UV Resources provides a convenient means of monitoring multiple Ultraviolet "C" (UV-C) fixtures installed in individual AHUs. The UV-Com automates the conventional means of "manually checking" that lamps and ballasts are operational and communicates this lamp status to most BAS/BMS. A single UV-Com control panel can simultaneously monitor up to eight separate UV-C fixtures. Multiple UV-Com panels can be linked together in a daisy-chain sequence in order to monitor as many individual UV-C fixtures as necessary.



— UV Resources

[www.uvresources.com](http://www.uvresources.com)

## HEATER WEBSITE



Cambridge Engineering, a manufacturer of high-temperature heating and ventilation (HTHV) products for large commercial spaces, launched a new website featuring an engineer-specific portal. The company says the portal allows for easier access to technical information to aid in the design and specification of its HTHV heaters. The new site features access to product overviews, engineering specifications, case studies, and building studies. There is also a registration component that allows specifying engineers to download CAD installation and dimensional drawings.

— Cambridge Engineering

[www.cambridge-eng.com](http://www.cambridge-eng.com)